



## Engine Control Module (ECM) Cooling Fan (18.30.80)

### Removal

#### NOTE :

To remove the ECM cooling fan, it is necessary to prise the cooling fan assembly from the ECM housing. When installing the ECM cooling fan, two holes will have to be drilled into the ECM housing.

1. Disconnect the battery ground cable. For additional information, refer to [Specifications](#) (Section 414-00 Charging System - General Information)
2. Remove the ECM. For additional information, refer to [Engine Control Module \(ECM\) \(18.30.03\)](#) (Section 303-14A Electronic Engine Controls - 4.0L)
3. Remove the cooling fan assembly.
  - Release the ECM cooling fan electrical connector from the ECM housing.
  - Apply an even and constant pressure to the fan assembly, until it releases from the ECM housing.

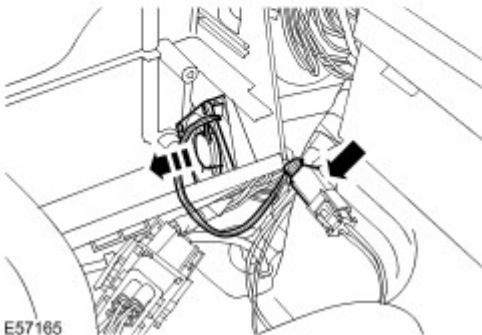
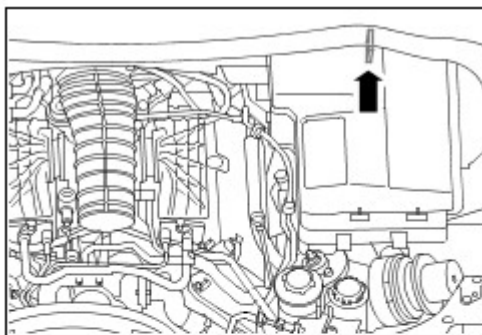

### Installation

1. Install the ECM cooling fan assembly.
  - Check the fan location site for obstruction and remove if required.
  - Position the cooling fan and mark the fitted position.
  - Drill 2 holes, 2 mm diameter, at the positions marked.
  - Secure the cooling fan with 2 self tapping screws.

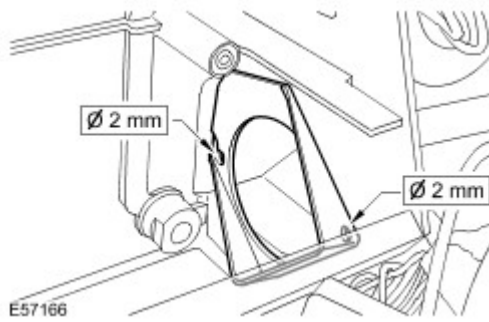

2. Secure the electrical connector to the ECM housing.
3. Install the ECM. For additional information, refer to [Engine Control Module \(ECM\) \(18.30.03\)](#) (Section 303-14A Electronic Engine Controls - 4.0L)
4. Connect the battery ground cable. For additional information, refer to [Specifications](#) (Section 414-00 Charging System - General Information)